



SERVICE BULLETIN

Classification: TE09-001a	Reference: NTB10-012a	Date: June 16, 2011
------------------------------	--------------------------	------------------------

ESSENTIAL TOOL; J-49829 7 SPEED A/T FILL PUMP

This bulletin has been amended. The Title, APPLIED VEHICLES, and the ATF level check procedure has been amended. Please discard previous versions of this bulletin.

APPLIED VEHICLES: 2010 - 2011 370Z and Roadster (Z34) with 7 Speed A/T using Nissan Matic S ATF

SERVICE INFORMATION

When filling up, checking the ATF level, or if the pan of a RE7R01 series 7 speed automatic transmission has been drained or removed, a special tool must be used.

- This special tool is the “Transmission Fill Pump”, J-49829.
- This special tool is considered "Essential" and was sent to each dealer on January 19, 2010. Your Non-Vehicle account will be charged the introductory price of \$177.85 plus applicable taxes and freight.
- For proper use of this tool, go to **ATF Level Check** starting on Page 2.

CAUTION: Fill the Transmission Fill Pump with new Nissan Matic S ATF (999MP-MTS00P) only. **Never** fill with any other fluid.

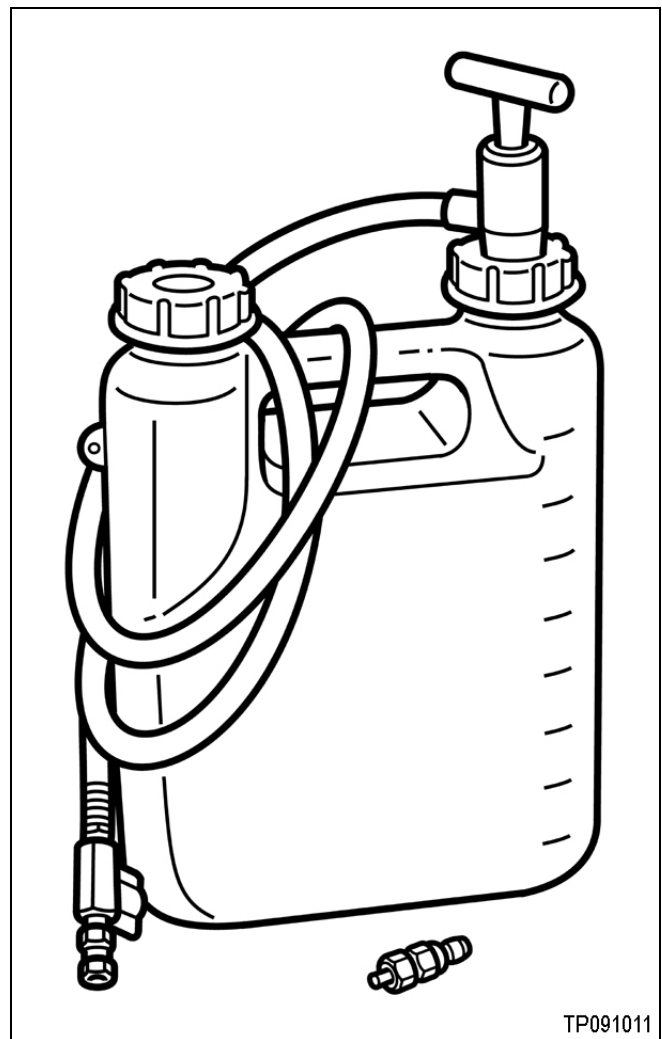

TP091011

Tool J-49829

ATF Level Check

1. Park the vehicle on a lift and set the parking brake.
2. Connect CONSULT III (C-III) to the vehicle.
3. With C-III, monitor ATF temperature.

NOTES:

- ATF temperature must be maintained at 95-113°F (35-45°C) during ATF level check.
 - If the ATF temperature is above 113°F, stop the engine to allow the ATF to cool down.
4. Once the ATF temperature reaches approximately 104°F (40°C) or below, start the engine and let idle.
 5. Shift the shift selector lever (shift lever) in each gear position, and then return to Park.
 6. Raise the vehicle on the lift.

NOTE: Leave the engine idling. If the engine is turned off, the ATF fluid level will be adjusted well below the proper level.

7. Remove the overflow plug from the transmission pan (see Figure 1).
 - Have a drain pan positioned under the overflow plug hole.
 - At first, an initial amount of fluid may come out. This does not mean the transmission is full.

NOTE: The engine MUST BE IDLING the whole time during the fluid level check. If the engine is turned off, the ATF fluid level will be adjusted well below the proper level.

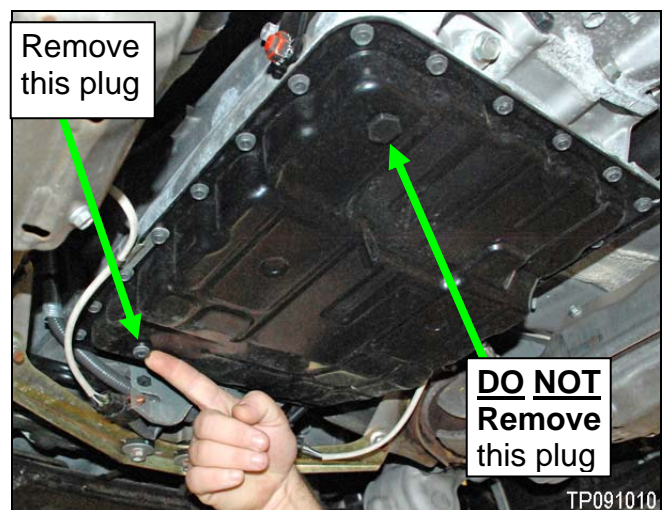

Figure 1

IMPORTANT: In order to make sure the transmission is full; you must overfill the transmission, and then let the excess drain out from the overflow plug hole.

- 8 Connect the Transmission Fill Pump at the overflow plug hole (see Figure 2).
9. Pump in approximately 2 liters (about 2 quarts) of Nissan Matic S ATF.



Figure 2

10. Disconnect the Fill Pump hose at the quick disconnect (see Figure 2).

- If a steady stream of fluid drains out, go to the next step.

IMPORTANT: The amount of fluid that drains out should be enough so that it is obvious the fluid was overfull and is now draining to the correct level.

NOTE: The engine **MUST BE IDLING** the whole time during the fluid level check. If the engine is turned off, the ATF fluid level will be adjusted well below the proper level.

- If little or no fluid drains out, repeat Step 8 and 9.

11. Allow fluid to drain from the overflow tube until it is just a drip.

NOTE: Check to make sure the fluid temperature is still in specified range (35-45°C, 95-113°F).

12. Install a new overflow plug. This completes the ATF level check.

- Torque the filler plug to 12.4 N•m (1.3 kg-m, **9 ft lb**).

Refill After Draining / Removing the Pan

1. With the pan and drain plug installed, connect the Transmission Fill Pump at the overflow plug hole and then fill the pan with approximately 4 liters (about 4 US quarts) of Nissan Matic S ATF.
2. Perform **ATF Level Check**, starting on Page 2.