



SERVICE BULLETIN

Classification: AT11-009	Reference: NTB11-061	Date: June 16, 2011
-----------------------------	-------------------------	------------------------

NISSAN; INFORMATION FOR 7 SPEED ATF

APPLIED VEHICLES: 2009 - 2011 370Z and 2010 - 2011 370Z Roadster (Z34)
with 7 Speed A/T using Nissan Matic S ATF

SERVICE INFORMATION

When inspecting or servicing a 7 speed transmission, you may find that the fluid color is darker than expected. In the first 2,000 to 3,000 miles of operation, the fluid (Nissan Matic S - 999MP-MTS00P) will become darker in color than new fluid.

The photo in Figure 1 shows an example of fluid darkening after 3,500 miles of operation in a 7 Speed transmission.

- This fluid darkening is a normal condition.
- The fluid does not need to be changed because of the darkening.
- The fluid's lubrication properties and quality are not diminished because of the darkening.

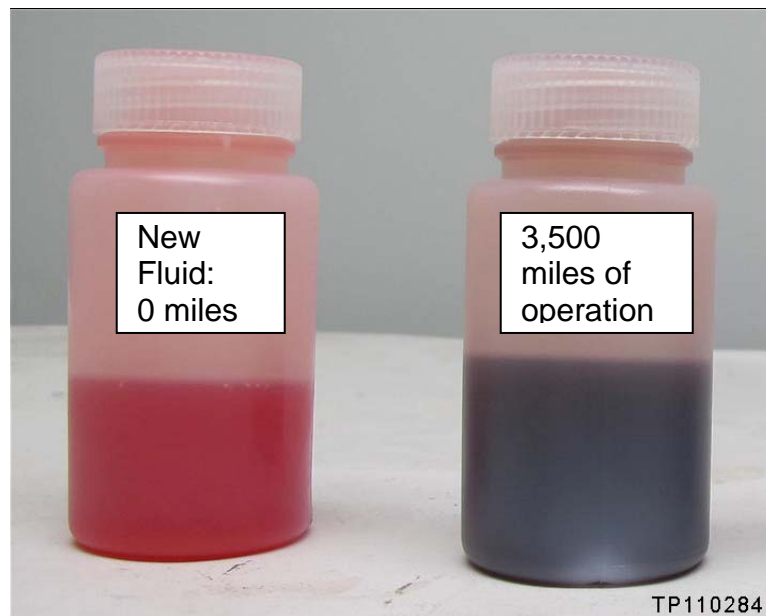

Figure 1

NOTE: The 7 Speed A/T requires Special Tool J-49829 for transmission fluid fill and level check. The level check procedure is included in this bulletin on the next page.

Nissan Bulletins are intended for use by qualified technicians, not 'do-it-yourselfers'. Qualified technicians are properly trained individuals who have the equipment, tools, safety instruction, and know-how to do a job properly and safely. NOTE: If you believe that a described condition may apply to a particular vehicle, DO NOT assume that it does. See your Nissan dealer to determine if this applies to your vehicle.

ATF Level Check

1. Park the vehicle on a lift and set the parking brake.
2. Connect CONSULT III (C-III) to the vehicle.
3. With C-III, monitor ATF temperature.

NOTES:

- ATF temperature must be maintained at 95-113°F (35-45°C) during ATF level check.
 - If the ATF temperature is above 113°F, stop the engine to allow the ATF to cool down.
4. Once the ATF temperature reaches approximately 104°F (40°C) or below, start the engine and let idle.
 5. Shift the shift selector lever (shift lever) in each gear position, and then return to Park.
 6. Raise the vehicle on the lift.

NOTE: Leave the engine idling. If the engine is turned off, the ATF fluid level will be adjusted well below the proper level.

7. Remove the overflow plug from the transmission pan (see Figure 1).
 - Have a drain pan positioned under the overflow plug hole.
 - At first, an initial amount of fluid may come out. This does not mean the transmission is full.

NOTE: The engine MUST BE IDLING the whole time during the fluid level check. If the engine is turned off, the ATF fluid level will be adjusted well below the proper level.

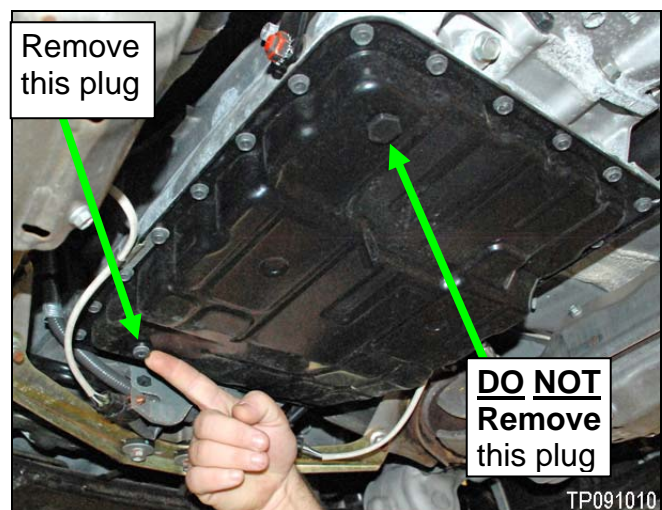

Figure 1

IMPORTANT: In order to make sure the transmission is full; you must overfill the transmission, and then let the excess drain out from the overflow plug hole.

8. Connect the Transmission Fill Pump at the overflow plug hole (see Figure 2).
9. Pump in approximately 2 liters (about 2 quarts) of Nissan Matic S ATF.



Figure 2

10. Disconnect the Fill Pump hose at the quick disconnect (see Figure 2).

- If a steady stream of fluid drains out, go to the next step.

IMPORTANT: The amount of fluid that drains out should be enough so that it is obvious the fluid was overfull and is now draining to the correct level.

NOTE: The engine **MUST BE IDLING** the whole time during the fluid level check. If the engine is turned off, the ATF fluid level will be adjusted well below the proper level.

- If little or no fluid drains out, repeat Step 8 and 9.

11. Allow fluid to drain from the overflow tube until it is just a drip.

NOTE: Check to make sure the fluid temperature is still in specified range (35-45°C, 95-113°F).

12. Install a new overflow plug. This completes the ATF level check.

- Torque the filler plug to 12.4 N•m (1.3 kg-m, **9 ft lb**).

Refill After Draining / Removing the Pan

1. With the pan and drain plug installed, connect the Transmission Fill Pump at the overflow plug hole and then fill the pan with approximately 4 liters (about 4 US quarts) of Nissan Matic S ATF.
2. Perform **ATF Level Check**, starting on Page 2.