



SERVICE BULLETIN

Classification:

EC12-015

Reference:

NTB12-054

Date:

June 26, 2012

WHEN REPLACING CONFIGURABLE BCM

APPLIED VEHICLES: All with configurable BCM

SERVICE INFORMATION:

Before replacing a configurable BCM, always select **Save** Configuration whether or not it has any manually configurable options.

After replacement “Write Configuration” **MUST** then be performed and **OK** selected, even if there are not any options listed. (See Figure 2)

IMPORTANT:

- Auto settings are not visible in CONSULT III plus and it is not possible to confirm these settings.
- If original BCM is damaged and “Saving” configuration is not possible:
 - Replace BCM, perform the “Write Configuration” and select OK to insure “auto” settings are correct. *Even if manual settings are correct or there are no manual settings.*

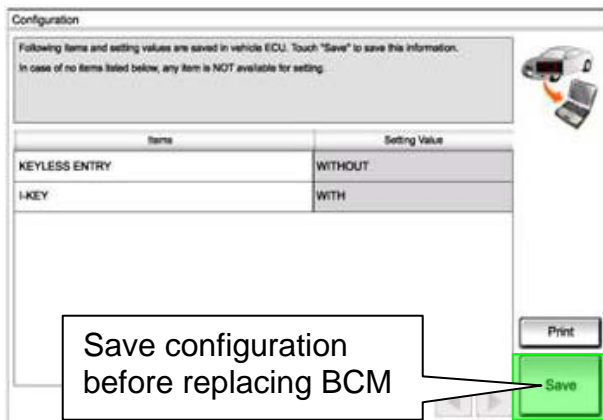

Figure 1

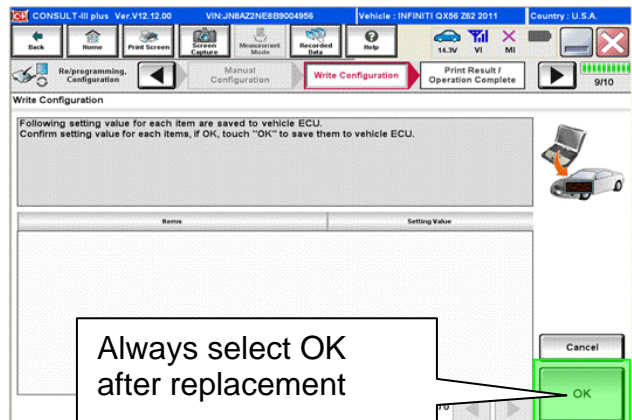

Figure 2

After configuration is completed:

1. Register I-Keys
2. Register Fob (If applicable)
3. Complete TPMS registration

Nissan Bulletins are intended for use by qualified technicians, not 'do-it-yourselfers'. Qualified technicians are properly trained individuals who have the equipment, tools, safety instruction, and know-how to do a job properly and safely. NOTE: If you believe that a described condition may apply to a particular vehicle, DO NOT assume that it does. See your Nissan dealer to determine if this applies to your vehicle.